

## Double Cantilever Arm — Back to Back (HDG)

Heavy Duty 2.5mm Mild Steel | 41 × 41mm Channel Welded Back-to-Back | Hot Dip Galvanised | Fits up to M12 | Internal & External

Direct Channel Back-to-Back Cantilever Arms are heavy-duty support arms formed from two 41 × 41mm channel profiles welded back-to-back and welded to an 8mm thick two-hole back plate. Hot Dip Galvanised (HDG) for corrosion resistance, they are suitable for both internal and external installations.

The back plate (150mm × 45mm) carries 2 × 14mm holes for fixings up to M12, bolting directly to strut channel or structure. Ideal for trapeze assemblies, cable tray / ladder and pipework support. Compatible with standard 41mm channel systems; sold individually. Available in 300mm to 900mm projections.

SPECIFICATION	
Product Type	Twin (back-to-back) cantilever arm
Material	2.5mm Mild Steel
Finish	Hot Dip Galvanised (HDG)
Channel Profile	41 × 41mm, welded back-to-back
Back Plate	8mm thick, 150 × 45mm, 2-hole
Fixing Holes	2 × 14mm — fits up to M12
Projections	300, 450, 600, 750, 900
Use	Internal & external
Compatibility	Standard 41mm channel & brackets
Supply	Sold individually

### KEY FEATURES

- Twin 41 × 41mm channel welded back-to-back — high rigidity
- Heavy-duty 2.5mm mild steel construction
- Hot Dip Galvanised (HDG) — corrosion resistant
- 8mm thick 2-hole back plate (150 × 45mm)
- 2 × 14mm fixing holes — suit up to M12 bolt
- Five projections: 300, 450, 600, 750, 900mm
- Suitable for internal & external use
- Compatible with standard 41mm channel & brackets

### TECHNICAL DRAWING

DIM.	PARAMETERS						
*A*	150	300	450	600	750	900	1000

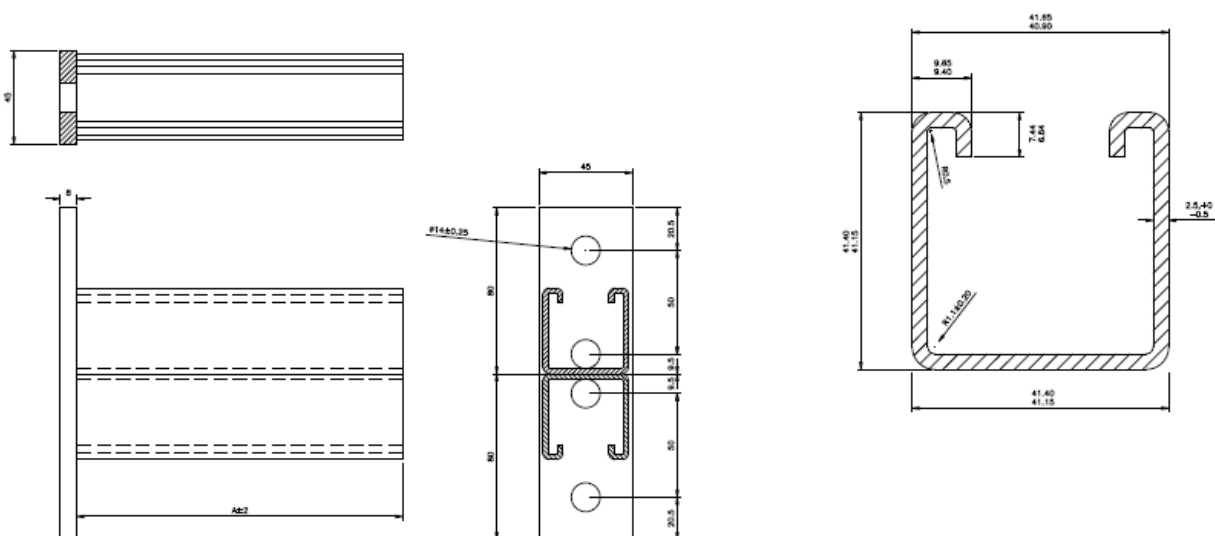

MATERIAL: MILD STEEL

**TOLERANCE - U.N.O**  
**DIMS.** - ±1mm  
**ANGLES** - ±0.5°

Back-to-back cantilever arm — dimensions in mm, not to scale.

**AVAILABLE SIZES & LOAD RATINGS**

Code	Projection	LOAD 1 — UDL (kN)	LOAD 2 — Centre (kN)	LOAD 3 — End (kN)	Finish
CLA300BB	300mm	5.53	5.53	2.76	HDG
CLA450BB	450mm	3.66	3.66	1.87	HDG
CLA600BB	600mm	2.76	2.76	1.36	HDG
CLA750BB	750mm	2.20	2.20	1.09	HDG
CLA900BB	900mm	-	-	-	HDG

LOAD 1 = Uniformly Distributed Load · LOAD 2 = Centre Point Load · LOAD 3 = End Point Load. Figures are guidance load ratings in kN — verify against project requirements and apply an appropriate factor of safety. Load data for CLA900BB available on request.

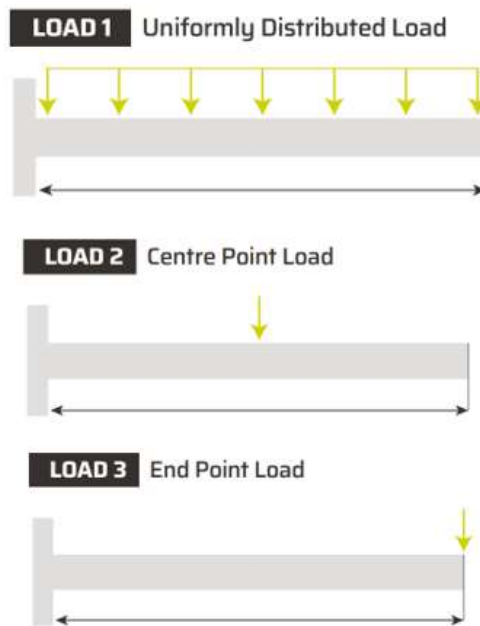
**TYPICAL APPLICATIONS**

Trapeze and cantilever bracket assemblies Cable tray, ladder and basket support Pipework and conduit support off walls or columns	HVAC and M&E plant support External and exposed structural fixing (HDG) Building services and plant-room installations
---	--

**To Order:** Visit [directchannel.uk.com](http://directchannel.uk.com) or call **0121 270 8507** | Trade & bulk enquiries: [sales@directchannel.uk.com](mailto:sales@directchannel.uk.com) | Most orders dispatched same or next working day.

**DISCLAIMER & LEGAL NOTICE**

Direct Channel Support Systems Ltd has made every reasonable effort to ensure the accuracy and completeness of the information contained in this datasheet. All product specifications, dimensions, and technical details are provided for guidance purposes only. Direct Channel Support Systems Ltd reserves the right to alter, update, or withdraw any product or specification at any time and without prior notice. To the fullest extent permitted by law, Direct Channel Support Systems Ltd accepts no liability for any loss, damage, or consequential loss arising from reliance on the information contained herein. Customers are advised to verify all specifications prior to ordering. For the most current product information visit [directchannel.uk.com](http://directchannel.uk.com) or contact our sales team.